

I DR III BLDC RESIN TYPE MOTOR FOR REFRIGERATOR (B-PJT)

REFRIGERATOR MOTOR

MOTOR



DRAWING

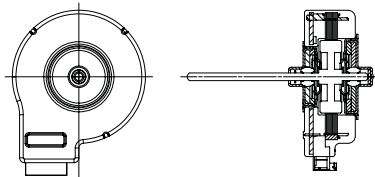

CLASS

SPECIFICATION

Rated Voltage

DC 12 V

Speed Control

Voltage Control

Rated power

1.4 ~ 1.62 W

Rated RPM

1,500 ~ 2,750 RPM

Efficiency

45 %